



**Stewarts of America**

Pinned Sleeve  
Questionnaire

Type of Machine  
Machine Manufacturer  
Type of Material to be Perfed  
Thickness of Material  
Application Hot / Cold

**Ring Dims:**

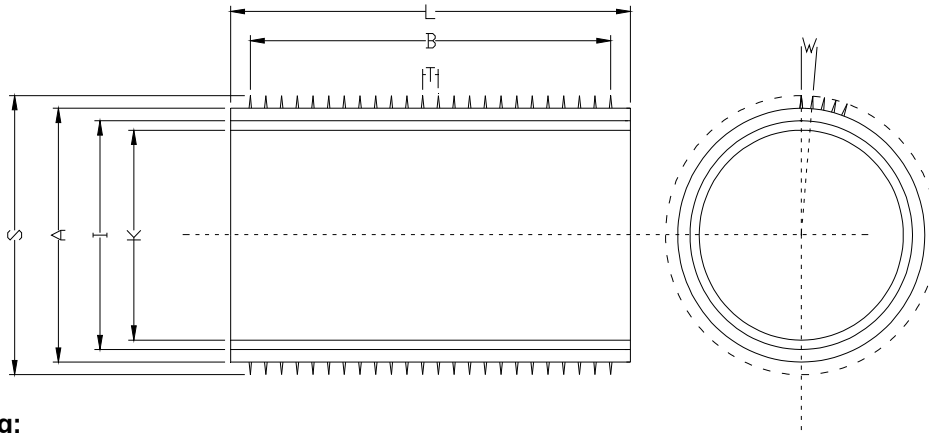

**Pinned Ring:**

L = Roller Length  
B = Pinning Width  
I = Ring Inner Diameter  
A = Ring Outer Diameter  
S = Diameter Over Pins  
K = Inside Diameter to Fit Shaft

	mm
	mm
	mm
	mm
	mm
	mm

1 = no offset, ie. Rows behind each other  
2 = staggered  
3 = More than 2: spiral  
4 = Other

**Pin Pattern:**

**Pinning:**

D = Pin Diameter  
T = Pin Spacing  
N = Pin Length  
F = Pin Protruding Length  
W = Distance Between Pin Rows  
U = Pin Angle (Vertical =0)  
R = No. of Pin Rows (circumference)  
P = Number of Pins Per Row  
X = Stagger Angle

	mm
	mm
	mm
	mm
	degree
	degree

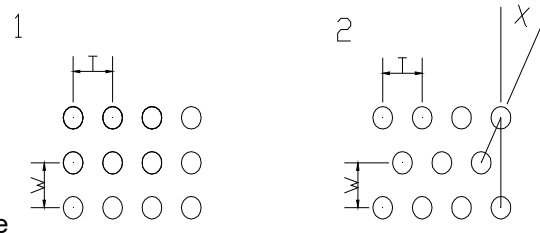

**Alignment:**

Alignment pin type?  
Pattern Continious?



Stewarts of America Inc.  
2825 Kemet Way Simpsonville SC 29681  
Phone: 1-864-967-7085 Fax 1-864-967-4361  
E-mail: [sales@stewartsofamerica.com](mailto:sales@stewartsofamerica.com)

